

Internal door mount

HEX260PA-A series

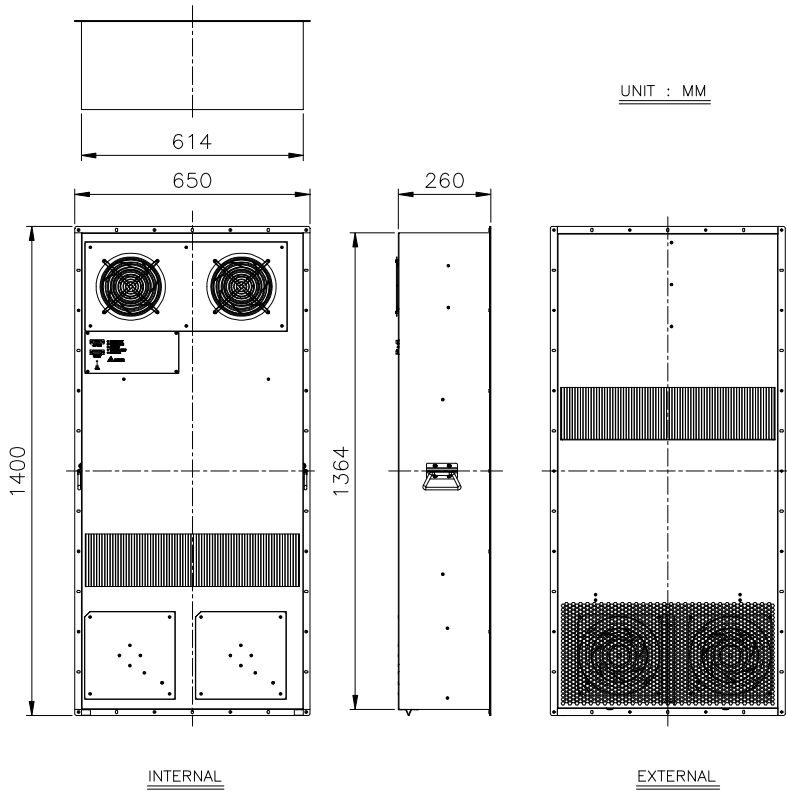

Dimension drawing



Features

- ◆ IP55 waterproof at external side
- ◆ "One touch" dry run test and dust cleaning
- ◆ Standalone temperature control
- ◆ Clear LED status indicator
- ◆ Dry contact alarm output

Design

- ◆ Air to air heat exchange
- ◆ Rated voltage at 48V
- ◆ Redundant fan quantity design
- ◆ High efficiency and reliable fan
- ◆ Easy installation and maintenance

Main feature	Unit	Specification	
Dimension (H x W x D)	mm (in)	1400 x 650 x 260 (55 x 26 x 10)	
Cooling capacity* _{Note}	W/K (W/°F)	175 (97)	230 (128)
Rated voltage	VDC	48	
Operating current	A	3.1	10.0
Operating power	W	149	480
Operating voltage range	VDC	40 ~ 60	
Operating temperature range	°C	-10 ~ +65	
Noise (1.5 meter)	dB-A	65.0	75.0
Weight	Kg (Lb)	37 (82)	

* Note : The cooling capacity (W/K , W/°C or W/°F) is defined as Q/ (TI-TA)

Q : Heat dissipation (W) from inside of cabinet

TI : Return temperature of internal air circuit (K , °C or °F)

TA : Ambient temperature of external air circuit (K , °C or °F)

* Specifications are subject to change without notice.